



**DS-PK201B-WE&WB&WA Wireless LED
Keypad**

User Manual

Contents

Chapter 1 Unboxing Video	1
Chapter 2 Components Introduction	2
Chapter 3 Enrollment via App	4
Chapter 4 Installation	5
4.1 Installation Preparation	5
4.2 Mounting with Screws	5
Chapter 5 Configure via App	7
Chapter 6 Operation Command	8
Chapter 7 Specifications	9
Appendix A. Legal Information	10
Appendix B. Symbol Conventions	12

Chapter 1 Unboxing Video

Watch the video to get the device general information.

Refer to the video for details:

Refer to the link to see the high-definition video: <https://enpinfodata.hikvision.com/analysisQR/showQR/b722d26f>

Chapter 2 Components Introduction

Check components location and name for further use.

Note

- Structures may differ in different models, please refer to the actual product.

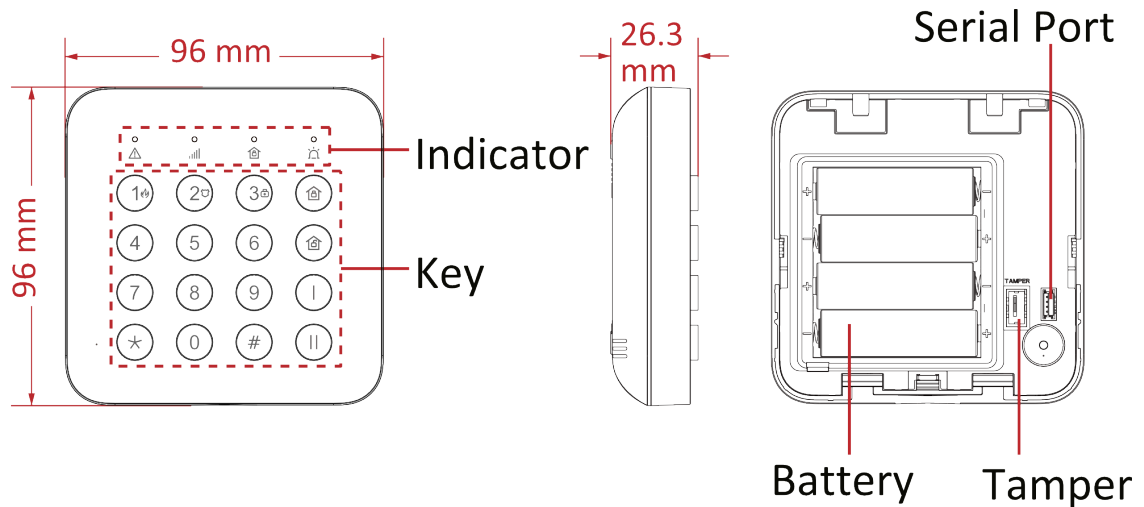

Table 2-1 LED Indication

Indicator	Indicator Status	Control Panel Status
	Solid orange	System fault
	Flashing orange	Enrolling
	Green flashes 7 times	Enrolled
	Flashing green	Find me
	Solid red	Armed
	Red turns off	Arming failed
	Green flashes 2 times	Disarmed
	Green turns off	Disarming failed
	Solid red	Lid opened alarm
	Flashing red	Event alarm
Backlight	White flashes 3 times	Operation failed
	White turns off	No key operation for 10 s

Table 2-2 Buzzer Indication

Buzzer Status	Operation
Beep once	Press the key
Beep twice	Operation completed
Beep 3 times	Operation failed

Chapter 3 Enrollment via App

Steps

1. Download Hik-Connect and log in.
2. Enroll the control panel to the App.



For more details, refer to the user manual of Hik-Connect App and control panel.

3. On the device list page, tap **Add Device**.
4. Tap **Device** → **+**.
5. Select adding method.
 - Select **Manual Adding**, scan the QR code or enter the serial No.



The QR code is usually on the back cover of the device.

- Select **Batch Adding**, the device will be enrolled to the control panel automatically.
6. Slide down to remove the rear cover. Install 4 batteries into the device. Orange LED starts to flash.

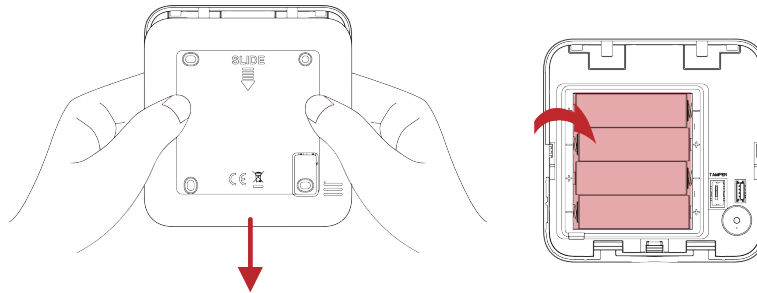

7. The green LED flashes for 7 times, the device is enrolled.

Chapter 4 Installation

4.1 Installation Preparation

Steps

1. Tap the device on the device list page. And tap  → **Signal Strength Test** to check signal strength.

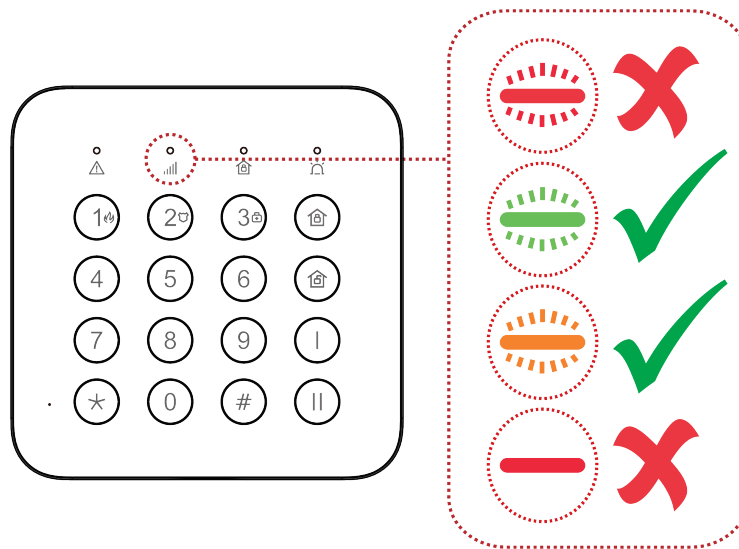

2. Check the environment.

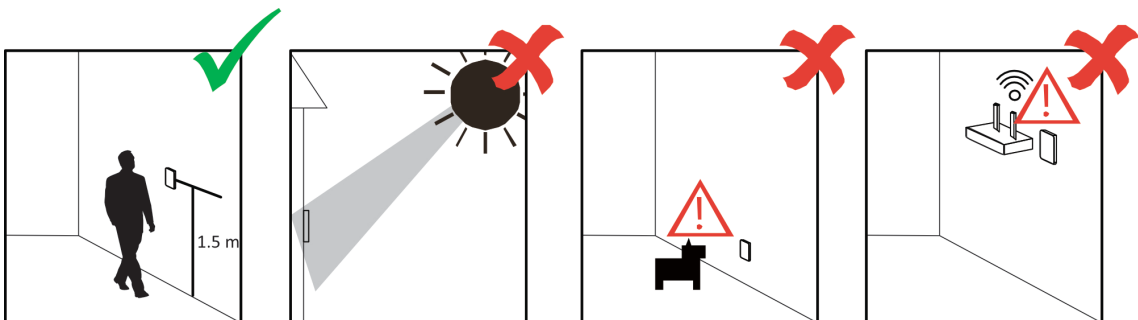
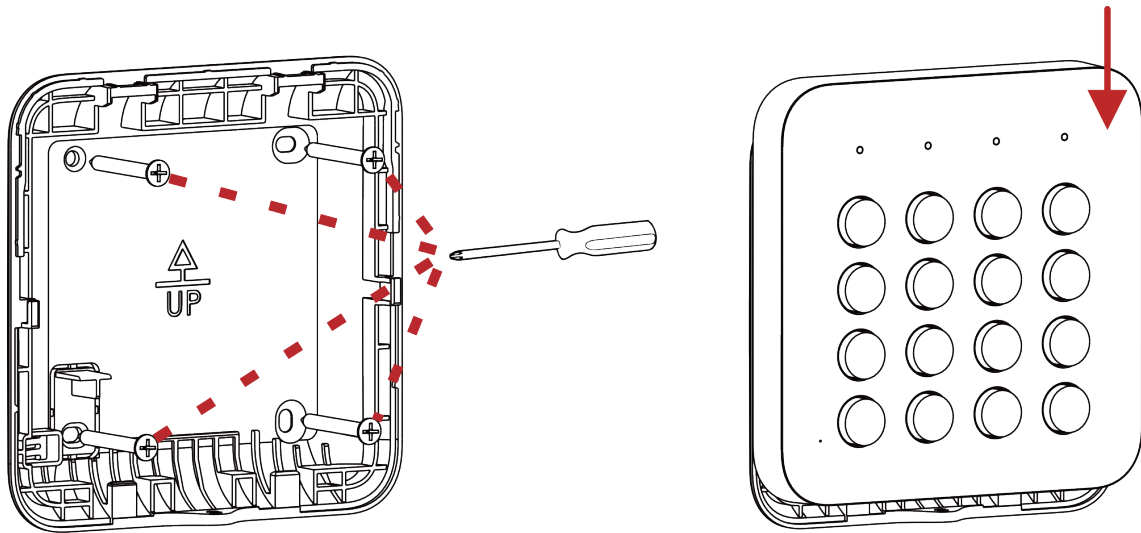

Figure 4-1 Environment Check

4.2 Mounting with Screws

Steps

1. Fix the rear cover to the wall with 4 screws. And install the front cover.



2. After the device is installed, you can view the device status, version, etc.

Chapter 5 Configure via App

Tap the device on the device list page, and tap  to configure device parameters.

Name

Edit device name.

Area

Select linked area or add new area.

Arming With Code

After enabled, you need to enter user password for arming.

Unauthorized Access Autolock

When the number of unauthorized accesses exceeds the set number, keys will be unlocked.

Auto-lock Time

After the set time, keys will be locked.

Function Buttons

Enable fire/medical/panic alarm.

Silent Panic Alarm/Silent Medical Alarm

After enabled, when alarm is triggered, it will not emit an alarm sound, but an alarm event will be uploaded.

Button Sound

After enabled, the buzzer will beep when you press the key.

Backlight

Enable backlight indication.

Alarm Sound

Enable the sound, the keypad will alarm when the alarm of control panel is triggered.

Delay Zone Indication

Enable the sound and LED indication when entering or exiting delay.





Deactivation

The selected part will be deactivated.

Find Me

Enter the find me mode to search for the device location.

Chapter 6 Operation Command

Command	Key
Away arming	User password + 
Disarming	User password + 
Silence alarm	User password +  (hold)
Duress	Duress password + 
Fire alarm	Hold key 1
Panic alarm	Hold key 2
Medical alarm	Hold key 3
Delete the last key value (Only for password)	*

Chapter 7 Specifications

Model WE: 868 Mhz WB: 433 Mhz WA: 915 Mhz	DS-PK201B-WE	DS-PK201B-WB	DS-PK201B-WA
Installation	Indoors		
Keypad type	Physical keypad		
Indication method	Buzzer and LED		
User passcode	Yes		
Protection against code guessing	Yes		
Duress code	Yes		
Power supply	4 × AA batteries		
Power consumption	Max current: 190 mA Quiescent current: 37 uA		
Battery life	Up to 2 years (standby time)		
Temperature indicator	Yes		
Transmission technology	Tri-X 868.0 - 868.6 MHz	Tri-X 433.1-433.7 MHz	Tri-X 912.5-917.4 MHz
Transmission range (free space)	Up to 1,600 m	Up to 1,200 m	Up to 1,600 m
Maximum effective radiated power (ERP)	Up to 25 mW	Up to 10 mW	Up to 60 mW
Tamper	Yes		
Operating temperature	-10°C to 55°C (14°F to 131°F)		
Operation humidity	10% to 90%		
Protection class of body	No		
Dimension (W × H × D)	96 × 96 × 26.3 mm		
Weight	127 g		

Appendix A. Legal Information

About this Document

- This Document includes instructions for using and managing the Product. Pictures, charts, images and all other information hereinafter are for description and explanation only.
- The information contained in the Document is subject to change, without notice, due to firmware updates or other reasons. Please find the latest version of the Document at the Hikvision website (<https://www.hikvision.com>). Unless otherwise agreed, Hangzhou Hikvision Digital Technology Co., Ltd. or its affiliates (hereinafter referred to as "Hikvision") makes no warranties, express or implied.
- Please use the Document with the guidance and assistance of professionals trained in supporting the Product.

About this Product

This product can only enjoy the after-sales service support in the country or region where the purchase is made.

Acknowledgment of Intellectual Property Rights

- Hikvision owns the copyrights and/or patents related to the technology embodied in the Products described in this Document, which may include licenses obtained from third parties.
- Any part of the Document, including text, pictures, graphics, etc., belongs to Hikvision. No part of this Document may be excerpted, copied, translated, or modified in whole or in part by any means without written permission.
- **HIKVISION** and other Hikvision's trademarks and logos are the properties of Hikvision in various jurisdictions.
- Other trademarks and logos mentioned are the properties of their respective owners.

LEGAL DISCLAIMER

- TO THE MAXIMUM EXTENT PERMITTED BY APPLICABLE LAW, THIS DOCUMENT AND THE PRODUCT DESCRIBED, WITH ITS HARDWARE, SOFTWARE AND FIRMWARE, ARE PROVIDED "AS IS" AND "WITH ALL FAULTS AND ERRORS". HIKVISION MAKES NO WARRANTIES, EXPRESS OR IMPLIED, INCLUDING WITHOUT LIMITATION, MERCHANTABILITY, SATISFACTORY QUALITY, OR FITNESS FOR A PARTICULAR PURPOSE. THE USE OF THE PRODUCT BY YOU IS AT YOUR OWN RISK. IN NO EVENT WILL HIKVISION BE LIABLE TO YOU FOR ANY SPECIAL, CONSEQUENTIAL, INCIDENTAL, OR INDIRECT DAMAGES, INCLUDING, AMONG OTHERS, DAMAGES FOR LOSS OF BUSINESS PROFITS, BUSINESS INTERRUPTION, OR LOSS OF DATA, CORRUPTION OF SYSTEMS, OR LOSS OF DOCUMENTATION, WHETHER BASED ON BREACH OF CONTRACT, TORT (INCLUDING NEGLIGENCE), PRODUCT LIABILITY, OR OTHERWISE, IN CONNECTION WITH THE USE OF THE



PRODUCT, EVEN IF HIKVISION HAS BEEN ADVISED OF THE POSSIBILITY OF SUCH DAMAGES OR LOSS.

- YOU ACKNOWLEDGE THAT THE NATURE OF THE INTERNET PROVIDES FOR INHERENT SECURITY RISKS, AND HIKVISION SHALL NOT TAKE ANY RESPONSIBILITIES FOR ABNORMAL OPERATION, PRIVACY LEAKAGE OR OTHER DAMAGES RESULTING FROM CYBER-ATTACK, HACKER ATTACK, VIRUS INFECTION, OR OTHER INTERNET SECURITY RISKS; HOWEVER, HIKVISION WILL PROVIDE TIMELY TECHNICAL SUPPORT IF REQUIRED.
- YOU AGREE TO USE THIS PRODUCT IN COMPLIANCE WITH ALL APPLICABLE LAWS, AND YOU ARE SOLELY RESPONSIBLE FOR ENSURING THAT YOUR USE CONFORMS TO THE APPLICABLE LAW. ESPECIALLY, YOU ARE RESPONSIBLE, FOR USING THIS PRODUCT IN A MANNER THAT DOES NOT INFRINGE ON THE RIGHTS OF THIRD PARTIES, INCLUDING WITHOUT LIMITATION, RIGHTS OF PUBLICITY, INTELLECTUAL PROPERTY RIGHTS, OR DATA PROTECTION AND OTHER PRIVACY RIGHTS. YOU SHALL NOT USE THIS PRODUCT FOR ANY PROHIBITED END-USES, INCLUDING THE DEVELOPMENT OR PRODUCTION OF WEAPONS OF MASS DESTRUCTION, THE DEVELOPMENT OR PRODUCTION OF CHEMICAL OR BIOLOGICAL WEAPONS, ANY ACTIVITIES IN THE CONTEXT RELATED TO ANY NUCLEAR EXPLOSIVE OR UNSAFE NUCLEAR FUEL-CYCLE, OR IN SUPPORT OF HUMAN RIGHTS ABUSES.
- IN THE EVENT OF ANY CONFLICTS BETWEEN THIS DOCUMENT AND THE APPLICABLE LAW, THE LATTER PREVAILS.

© Hangzhou Hikvision Digital Technology Co., Ltd. All rights reserved.

Appendix B. Symbol Conventions

The symbols that may be found in this document are defined as follows.

Symbol	Description
 Danger	Indicates a hazardous situation which, if not avoided, will or could result in death or serious injury.
 Caution	Indicates a potentially hazardous situation which, if not avoided, could result in equipment damage, data loss, performance degradation, or unexpected results.
 Note	Provides additional information to emphasize or supplement important points of the main text.

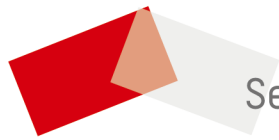

See Far, Go Further